

SMD POWER INDUCTORS: HL0618H Series

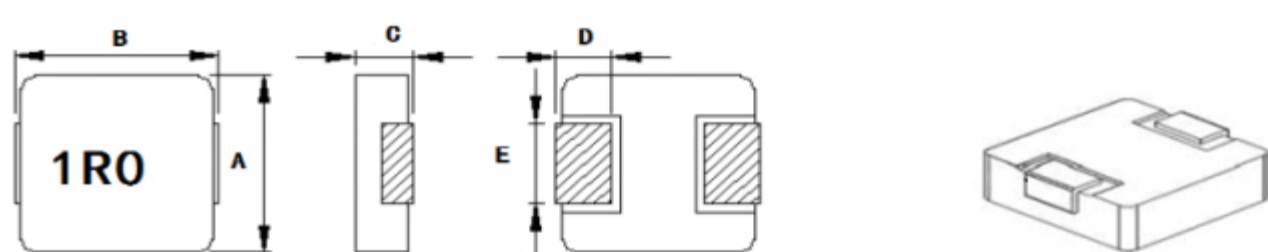

Series	A (mm)	B (mm)	C (mm)	D (mm)	E (mm)
HL0618H	6.6±0.3	7.6MAX	1.8MAX	1.6±0.5	3.0±0.3

Part Number	L0 Inductance (μH) ±20%	Heat Rating Current Irms(A)	Saturation Current Isat (A)	DCR (mΩ)	
				TYP.	MAX.
HL0618H-R10M-P	0.1	22.0	32.0	2.1	2.8
HL0618H-R22M-P	0.22	18.0	25.0	3.0	3.5
HL0618H-R33M-P	0.33	17.0	20.0	5.6	6.8
HL0618H-R68M-P	0.68	9.0	12.0	8.7	12.0
HL0618H-1R0M-P	1.0	8.0	11.0	18.0	20.0
HL0618H-2R2M-P	2.2	6.0	8.0	32.0	35.0
HL0618H-3R3M-P	3.3	4.0	7.0	50.0	55.0
HL0618H-4R7M-P	4.7	3.5	5.0	55.0	70.0
HL0618H-6R8M-P	6.8	2.8	4.0	80.0	110.0
HL0618H-100M-P	10.0	2.3	3.0	115.0	150.0

NOTES:

1. All test data is referenced to 25°C ambient
2. Operating Temperature Range -55°C to +150°C
3. Irms : DC current (A) that will cause an approximate ΔT of 40°C
4. Isat : DC current (A) that will cause Lo to drop approximately 30%
5. Test Frequency: 100KHZ,1.0V

SMD POWER INDUCTORS: HL0618H Series

Recommend Land Pattern Dimensions (推荐焊盘)

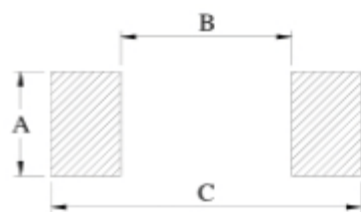

A	3.50
B	2.50
C	8.40

Unit : mm

Packaging Information (包装信息)

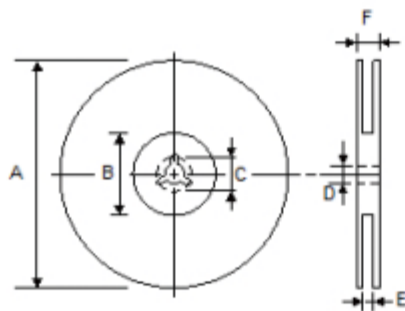

TYPE	A	B	C	D	E	F
16mm	330	100	21.0±0.8	13 ^{+0.5} / _{-0.2}	16±0.3	22.4

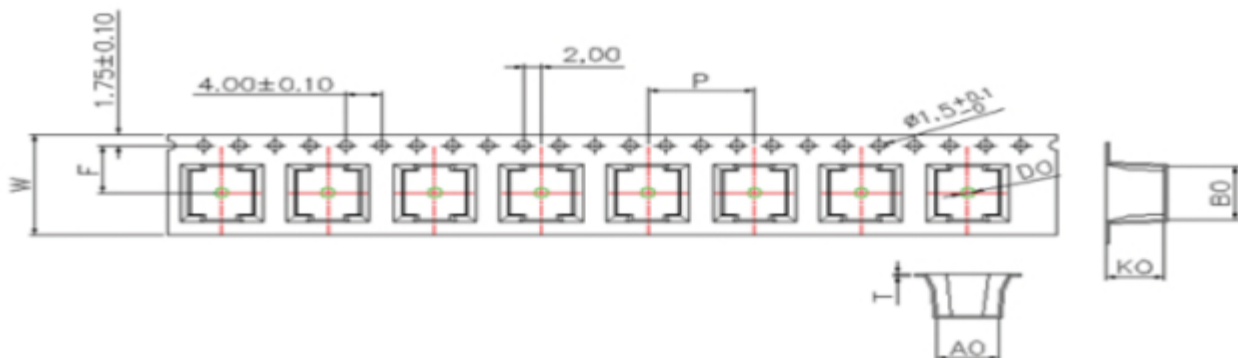

Q'TY (PCS)	A0	B0	KO	W	P	T
2000	7.0±0.1	7.8±0.1	2.3±0.1	16.0±0.3	12.0±0.1	0.35±0.05

- | | |
|-----------------------|--|
| ① 一卷包装: 2000Pcs; | ① One roll packing: 2000Pcs, |
| ② 小箱装两卷: 一共4000Pcs; | ② Small box packed with two volumes: a total of 4000Pcs; |
| ③ 大箱装三小箱: 一共12000Pcs. | ③ Big box three small boxes: a total of 12000Pcs. |