

PANEL CUT-OUT
PANET THICKNESS 1.27mm

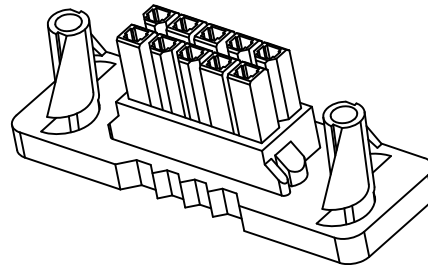
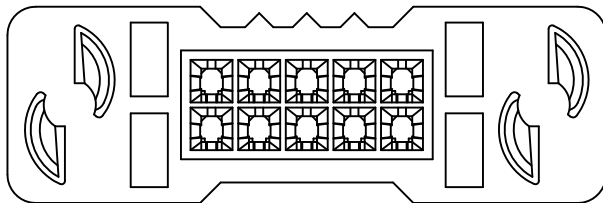
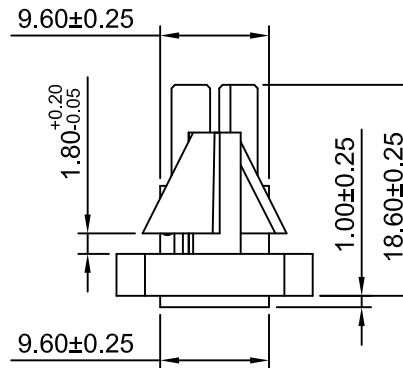
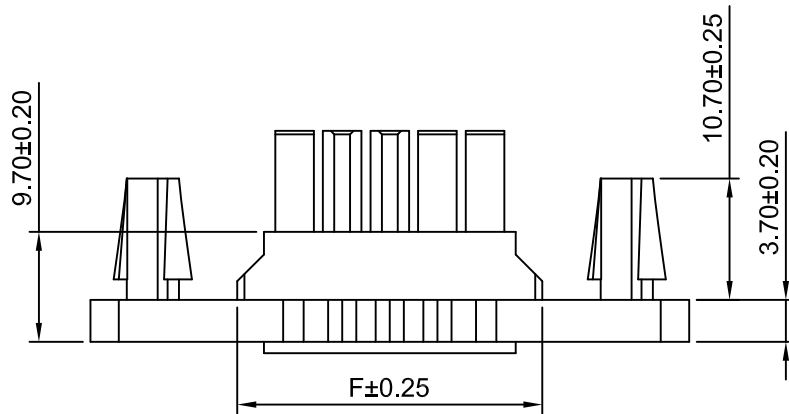

Ordering Information:

C4201HFB-2xXP - ** - **
1 2 3

1.Part NO.

2.Material:

(blank): Nylon 66 UL94V-2 (Natural)

V0: Nylon 66 UL94V-0 (White)

GWT: Nylon 66,UL94V-0 (Beige),
IEC 60335-1,5th Edition
Glow Wire Capable.

3.Color:

(blank): see section 2 Material

BK:Black RD:Red

YL:Yellow BL:Blue

GN:Green

SPECIFICATIONS:

Current Rating: 13A AC,DC (MAX)(Maximum current up to 13A when using the C4201F-TCA-HH series terminal)

Voltage Rating: 600V AC,DC

Temperature Range: -40°C ~ +105°C

Contact Resistance: 10mΩ Max

Insulation Resistance: 1000MΩ Min

Withstanding Voltage: 1500V AC/minute

Ordering Information & Dimensions

Part NO.	Dimensions(mm)						
	A	B	C	D	E	F	G
2x1P	---	36.15	25.00	13.40	8.70	10.10	5.40
2x2P	4.20	40.35	29.20	17.60	12.90	14.30	9.60
2x3P	8.40	44.55	33.40	21.80	17.10	18.50	13.80
2x4P	12.60	48.75	37.60	26.00	21.30	22.70	18.00
2x5P	16.80	52.95	41.80	30.20	25.50	26.90	22.20
2x6P	21.00	57.15	46.00	34.40	29.70	31.10	26.40
2x7P	25.20	61.35	50.20	38.60	33.90	35.30	30.60
2x8P	29.40	65.55	54.40	42.80	38.10	39.50	34.80
2x9P	33.60	69.75	58.60	47.00	42.30	43.70	39.00
2x10P	37.80	73.95	62.80	51.20	46.50	47.90	43.20
2x11P	42.00	78.15	67.00	55.40	50.70	52.10	47.40
2x12P	46.20	82.35	71.20	59.60	54.90	56.30	51.60
2x18P	71.40	107.55	96.40	84.80	76.78	81.50	76.80

Beijing Hongli Kumpeng International Trade Co., Ltd.

Unit	Scale	Sheet	TITLE
mm	1.5:1	1 of 1	4.20mm PITCH DUAL ROW WITH PANEL MOUNT EARS HOUSING
DRWN	CHK'D	APPR	
Dengchun Yi	Diankui Wan	Jack Yin	
General Tolerances		THIRD ANGLE PROJECTION	DRAWING NO.
x.xx±0.25			HLB-01-HFB-2xXP 76
x.xx±0.20			
x.xx±0.15			
ANGLES ±1°			REV A1

REV	DESCRIPTION	DATE
A1	CHANGE TOLERANCE	2021.08.13
A0	NEW RELEASE	2020.11.30