

ODD POSITIONS

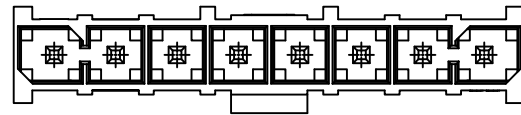

EVEN POSITIONS

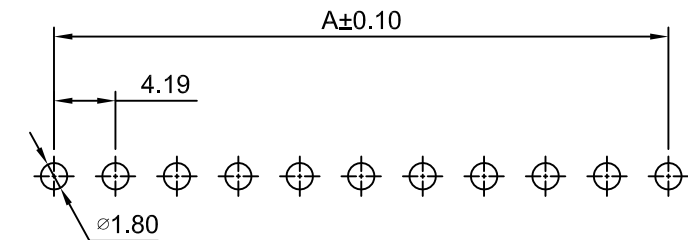
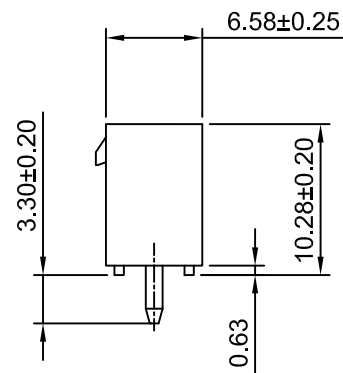
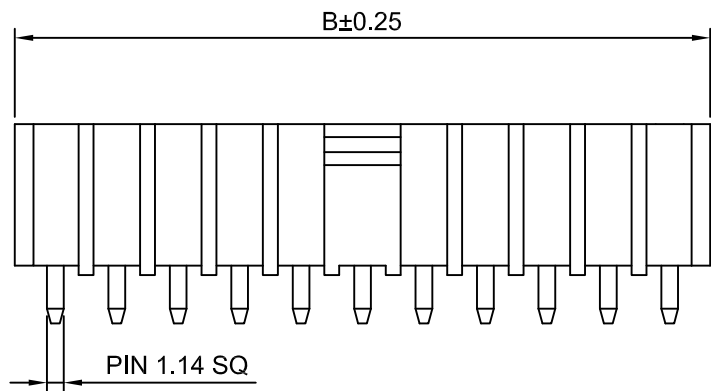

P.C.B LAYOUT
TOLERANCE:±0.05

Ordering Information:

C4201WVS-XP - $\frac{***}{1}$ - $\frac{***}{2}$ - $\frac{***}{3}$

- 1.Part NO.
- 2.Color:
(blank): Black
IV: Ivory
- 3.Finish:
(blank): Tin over Nickel
G: Gold over Nickel

SPECIFICATIONS:

Current Rating: 9A AC,DC
Voltage Rating: 600V AC,DC
Temperature Range: -55°C ~ +105°C
Contact Resistance: 10mΩ Max
After environmental testing: 20mΩ Max
Insulation Resistance: 1000MΩ Min
Withstanding Voltage: 1500V AC/minute
Pin Material:Brass
Material: LCP,UL94V-0

Ordering Information & Dimensions

Part NO.	Dimensions(mm)	
	A	B
C4201WVS-2P	4.19	9.72
C4201WVS-3P	8.38	13.91
C4201WVS-4P	12.57	18.10
C4201WVS-5P	16.76	22.29
C4201WVS-6P	20.95	26.48
C4201WVS-7P	25.14	30.67
C4201WVS-8P	29.33	34.86
C4201WVS-9P	33.52	39.05
C4201WVS-10P	37.71	43.24
C4201WVS-11P	41.90	47.43
C4201WVS-12P	46.09	51.62
C4201WVS-13P	50.28	55.81
C4201WVS-14P	54.47	60.00
C4201WVS-15P	58.66	64.19

Beijing Hongli Kungpeng International Trade Co., Ltd.

Unit	Scale	Sheet	TITLE
mm	2:1	1 of 1	4.19mm PITCH 180° SINGLE ROW DIP WAFER
DRWN	CHK'D	APPR	
Dengchun Yi	Dlankul Wan	Jack Yin	DRAWING NO.
General Tolerances			THIRD ANGLE PROJECTION
x.xx±0.25 x.xxx±0.20 x.xxxx±0.15 ANGLES ±1°			HLB-01-WVS-XP 71
REV			REV
DESCRIPTION			A3

A3	CHANGE THE SIZE	2020.11.05
A2	CHANGE THE DRAWING	2020.09.08
A1	CHANGE THE DRAWING	2019.11.30
A0	NEW RELEASE	2015.03.11
REV	DESCRIPTION	DATE