

**Ordering Information:**  
**C3030HM-2xXP-A - \*\*\***  
 1 / 2  
 1.Part No.  
 2.Material:  
 (blank):Nylon 66,UL94V-0  
 GWT:Nylon 66,UL94V-0,GWT 750°C

**SPECIFICATIONS:**  
 Current Rating: 12.5A AC,DC (AWG #18)  
 Voltage Rating: 600V AC,DC  
 Temperature Range: -40°C ~ +105°C  
 Contact Resistance: 10mΩ Max  
 Insulation Resistance: 1000MΩ Min  
 Withstanding Voltage: 1500V AC/minute  
 Material: Nylon 66,UL94V-0 (Black)

**Ordering Information & Dimensions**

Circuits	Dimensions(mm)		Circuits	Dimensions(mm)	
	A	B		A	B
2x1P	----	3.85	2x7P	18.00	21.85
2x2P	3.00	6.85	2x8P	21.00	24.85
2x3P	6.00	9.85	2x9P	24.00	27.85
2x4P	9.00	12.85	2x10P	27.00	30.85
2x5P	12.00	15.85	2x11P	30.00	33.85
2x6P	15.00	18.85	2x12P	33.00	36.85

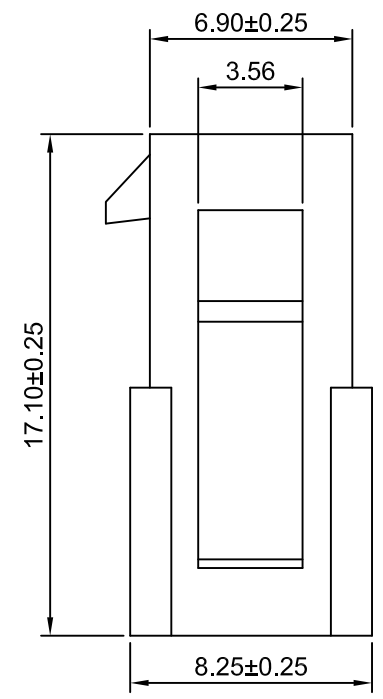
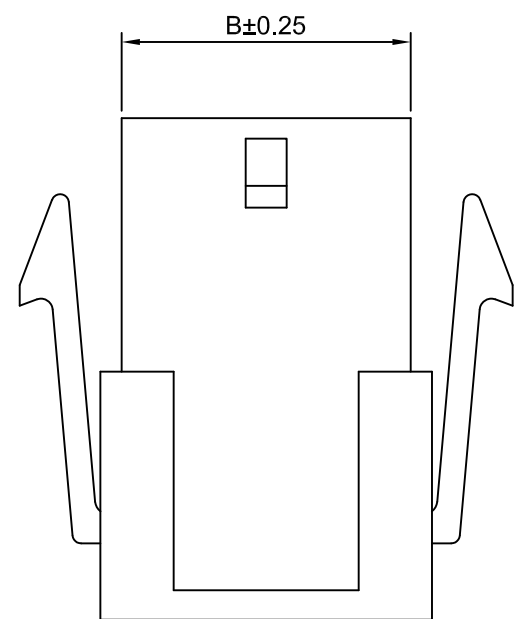

Beijing Hongli Kungpeng International Trade Co., Ltd.

Unit	Scale	Sheet	TITLE
mm	4:1	1 of 1	3.00mm PITCH
DRWN	CHK'D	APPR	Dual Row HOUSING
Xu Lei	Djankui Wan	Jack Yin	DRAWING NO.
General Tolerances			THIRD ANGLE PROJECTION
x.xx±0.25			
x.xxx±0.20			
x.xxxx±0.15			HLB-30-HM-2xXP-A 40
ANGLES ±1°			REV A2

A2	CHANGE THE DRAWING	2022.01.14
A1	CHANGE THE Current Rating	2018.12.15
A0	NEW RELEASE	2012.12.05
REV	DESCRIPTION	DATE