

2x1P~2x3P

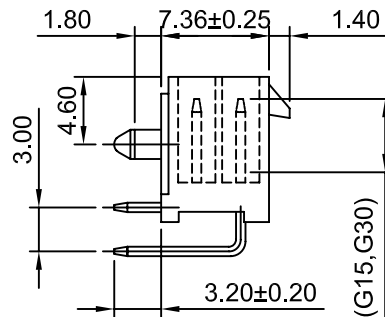

Gold-flash (G15, G30)

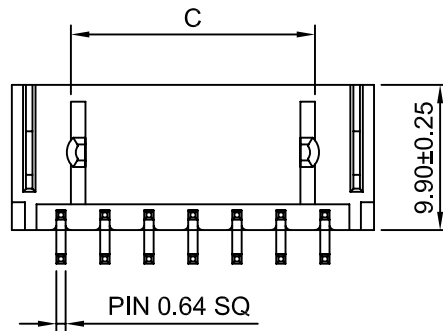
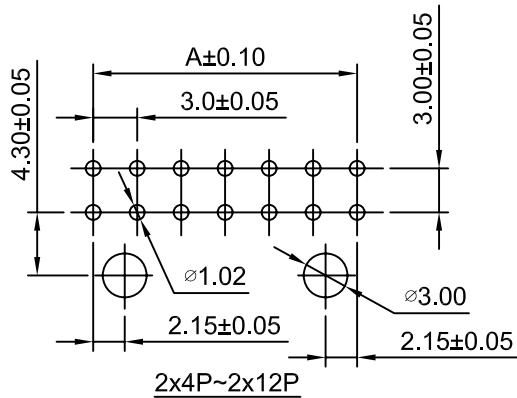

2x4P~2x12P

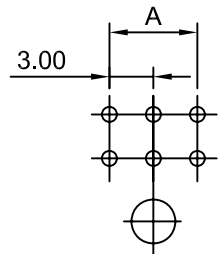

2x1P~2x3P

P.C.B LAYOUT

Ordering Information:

C3030WRA-F1-2xXP - **
1 2

1.Part No.

2.Finish:

(blank):Tin over Nickel

G:Gold-flash

G15:15μm (0.38μm) MIN.Select Gold
100μm (2.54μm) MIN.Select Tin

G30:30μm (0.76μm) MIN.Select Gold
100μm (2.54μm) MIN.Select Tin

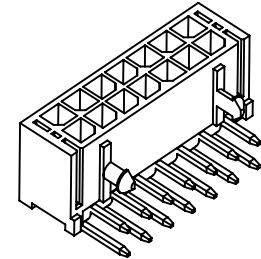

SPECIFICATIONS:

Current Rating: 5A AC,DC

Voltage Rating: 250V AC,DC

Temperature Range: -40°C ~ +265°C

Contact Resistance: 10mΩ Max

Insulation Resistance: 1000MΩ Min

Withstanding Voltage: 1500V AC/minute

Pin Material: Brass/Tin over Nickel

Material:Nylon 46,UL94V-0(Black)

Ordering Information & Dimensions

Circuits	Dimensions(mm)			Circuits	Dimensions(mm)		
	A	B	C		A	B	C
2x1P	---	6.70	2.90	2x7P	18.00	24.70	16.60
2x2P	3.00	9.70	2.90	2x8P	21.00	27.70	19.60
2x3P	6.00	12.70	2.90	2x9P	24.00	30.70	22.60
2x4P	9.00	15.70	7.60	2x10P	27.00	33.70	25.60
2x5P	12.00	18.70	10.60	2x11P	30.00	36.70	28.60
2x6P	15.00	21.70	13.60	2x12P	33.00	39.70	31.60

Beijing Hongli Kumpeng International Trade Co., Ltd.

Unit	Scale	Sheet
mm	2:1	1 of 1
Draw BY:	Approved :	
Tony Su	Jack Yin	

Title :
3.00mm PITCH
90° Dual Row WAFER

General Tolerance		
A0	NEW RELEASE	2012.12.06
REV	DESCRIPTION	DATE
	x.x≤0.25	ANGLE±
	x.xx≤0.20	
	x.xxx≤0.15	

DRAW NO :
HLB-30-WRA-F1-2xXP 29

REV
A0