

P.C.B LAYOUT

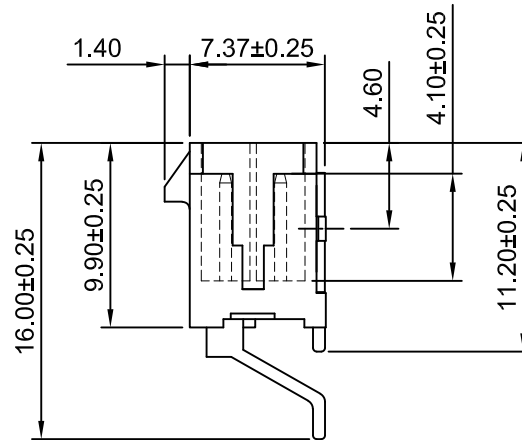
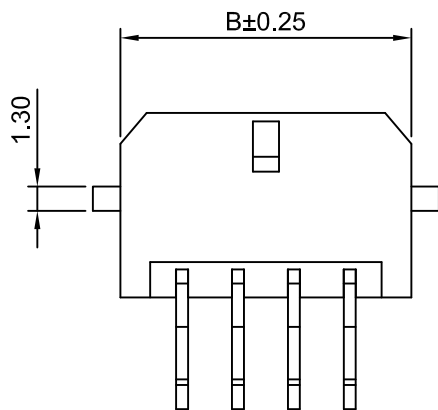

Ordering Information:

C3030WR-S-2xXP - *** - ***

1 2 3

1.Part No.

2.Material:

(blank):LCP,UL94V-0

GWT:LCP,UL94V-0,GWT 750°C

3.Finish:

(blank):Tin over Nickel

G:Gold over Nickel(1"U)

G3:Gold over Nickel(3"U)

G15:Gold over Nickel(15"U)

G30:Gold over Nickel(30"U)

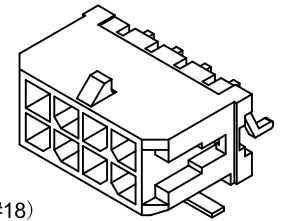

SPECIFICATIONS:

Current Rating: 12.5A AC,DC (AWG #18)

Voltage Rating: 600V AC,DC

Temperature Range: -40°C ~ +105°C

Contact Resistance: 10mΩ Max

Insulation Resistance: 1000MΩ Min

Withstanding Voltage: 1500V AC/minute

Pin Material: Brass/Tin over Nickel

Material: LCP,UL94V-0(Black)

Ordering Information & Dimensions

Circuits	Dimensions(mm)			Circuits	Dimensions(mm)		
	A	B	C		A	B	C
2x1P	---	6.65	11.20	2x7P	18.00	24.65	29.20
2x2P	3.00	9.65	14.20	2x8P	21.00	27.65	32.20
2x3P	6.00	12.65	17.20	2x9P	24.00	30.65	35.20
2x4P	9.00	15.65	20.20	2x10P	27.00	33.65	38.20
2x5P	12.00	18.65	23.20	2x11P	30.00	36.65	41.20
2x6P	15.00	21.65	26.20	2x12P	33.00	39.65	44.20

Beijing Hongli Kungpeng International Trade Co., Ltd.

Unit: mm, Scale: 2.5:1, Sheet: 1 of 1

DRWN: Xu Lei, CHK'D: DianKui Wan, APPR: Jack Yin

General Tolerances: x.xx±0.25, x.xxx±0.20, x.xxxx±0.15, ANGLES ±1°, THIRD ANGLE PROJECTION

TITLE: 3.00mm PITCH RIGHT-ANGLE Dual Row WAFER - SMT TYPE

DRAWING NO.: HLB-30-WR-S-2xXP 18, REV: A4

REV	DESCRIPTION	DATE
A4	CHANGE THE DRAWING	2022.01.17
A3	CHANGE THE DRAWING	2021.12.22
A2	CHANGE THE Current Rating	2018.12.19
A1	Update drawings	2011.12.14
A0	NEW RELEASE	2009.05.10