

P.C.B LAYOUT
TOLERANCE:±0.05

SPECIFICATIONS:
 Current Rating: 2A AC,DC
 Voltage Rating: 250V AC,DC
 Temperature Range: -40°C ~ +105°C
 Contact Resistance: 20mΩ Max
 Insulation Resistance: 1000MΩ Min
 Withstanding Voltage: 800V AC/minute
 Material: Nylon 66,UL94V-0(White)

Ordering Information & Dimensions

Part NO.	Dimensions(mm)	
	A	B
B2011HA-2P	2.00	4.40
B2011HA-3P	4.00	6.40
B2011HA-4P	6.00	8.40
B2011HA-5P	8.00	10.40
B2011HA-6P	10.00	12.40
B2011HA-7P	12.00	14.40
B2011HA-8P	14.00	16.40
B2011HA-9P	16.00	18.40
B2011HA-10P	18.00	20.40
B2011HA-11P	20.00	22.40
B2011HA-12P	22.00	24.40
B2011HA-13P	24.00	26.40
B2011HA-14P	26.00	28.40
B2011HA-15P	28.00	30.40
B2011HA-16P	30.00	32.40

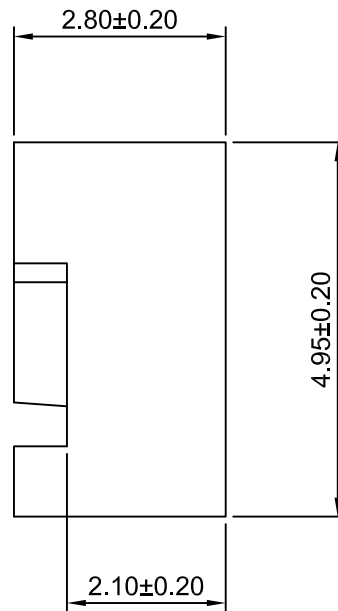
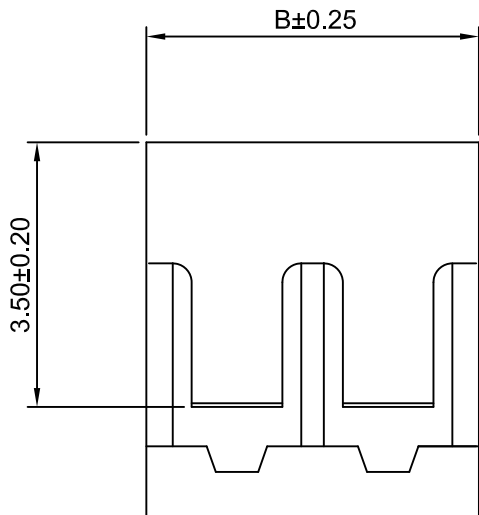

Beijing Hongli Kunpeng International Trade Co., Ltd.

Unit	Scale	Sheet	TITLE
mm	10:1	1 of 1	2.00mm PITCH HOUSING
DRWN	CHK'D	APPR	
Dengchun Yi	Diankui Wan	Jack Yin	
General Tolerances			THIRD ANGLE PROJECTION
x.xx±0.25 x.xxx±0.20 x.xxxx±0.15 ANGLES ±1°			DRAWING NO.
			HLB-11-HA-XP 2
			REV A1

REV	DESCRIPTION	DATE
A1	CHANGE THE DRAWING	2019.07.09
A0	NEW RELEASE	2015.06.01