

PCB LAYOUT

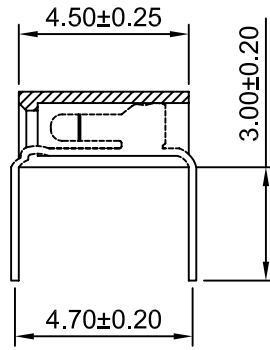
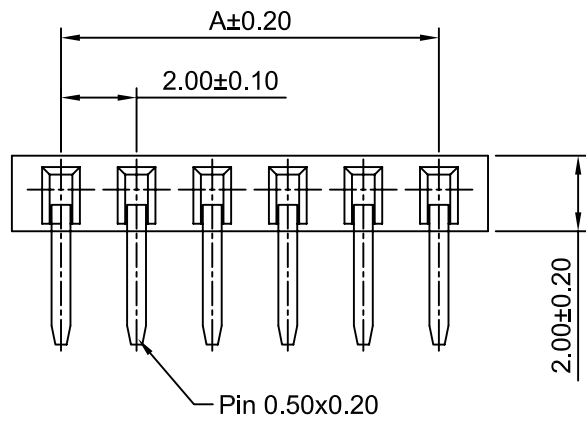

SPECIFICATIONS:

Current Rating: 2A AC,DC
 Voltage Rating: 250V AC,DC
 Temperature Range: -40°C ~ +105°C
 Contact Resistance: 20mΩ Max
 Insulation Resistance: 1000MΩ Min
 Withstanding Voltage: 500V AC/minute
 Pin Material: Phosphor Bronze/Gold over Nickel
 Material: Nylon 6T,UL94V-0(Black)

Ordering Information & Dimensions

| Circuits | Dim(mm) | | Circuits | Dim(mm) | | Circuits | Dim(mm) | |
|----------|---------|-------|----------|---------|-------|----------|---------|-------|
| | A | B | | A | B | | A | B |
| 2P | 2.00 | 4.60 | 15P | 28.00 | 30.60 | 28P | 54.00 | 56.60 |
| 3P | 4.00 | 6.60 | 16P | 30.00 | 32.60 | 29P | 56.00 | 58.60 |
| 4P | 6.00 | 8.60 | 17P | 32.00 | 34.60 | 30P | 58.00 | 60.60 |
| 5P | 8.00 | 10.60 | 18P | 34.00 | 36.60 | 31P | 60.00 | 62.60 |
| 6P | 10.00 | 12.60 | 19P | 36.00 | 38.60 | 32P | 62.00 | 64.60 |
| 7P | 12.00 | 14.60 | 20P | 38.00 | 40.60 | 33P | 64.00 | 66.60 |
| 8P | 14.00 | 16.60 | 21P | 40.00 | 42.60 | 34P | 66.00 | 68.60 |
| 9P | 16.00 | 18.60 | 22P | 42.00 | 44.60 | 35P | 68.00 | 70.60 |
| 10P | 18.00 | 20.60 | 23P | 44.00 | 46.60 | 36P | 70.00 | 72.60 |
| 11P | 20.00 | 22.60 | 24P | 46.00 | 48.60 | 37P | 72.00 | 74.60 |
| 12P | 22.00 | 24.60 | 25P | 48.00 | 50.60 | 38P | 74.00 | 76.60 |
| 13P | 24.00 | 26.60 | 26P | 50.00 | 52.60 | 39P | 76.00 | 78.60 |
| 14P | 26.00 | 28.60 | 27P | 52.00 | 54.60 | 40P | 78.00 | 80.60 |

Beijing Hongli Kunpeng International Trade Co., Ltd.

| | | |
|----------|-------|------------|
| Unit | Scale | Sheet |
| mm | 5:1 | 1 of 1 |
| Draw BY: | | Approved : |
| Tony Su | | Jack Yin |

Title :
**2.00mm PITCH
 90° Single Row Header**

DRAW NO :
HLB-05-HWRA-XP 94

REV
A0

| REV | DESCRIPTION | DATE |
|-----|-------------|------------|
| A0 | NEW RELEASE | 2017.11.01 |

| | |
|-------------------|--------|
| General Tolerance | |
| x.xx≤0.25 | ANGLE± |
| x.xx≤0.20 | |
| x.xx≤0.15 | |