

REV	DATE	DESCRIPTION

MATERIAL:  
Housing: PBT UL 94V-0  
Contacts: Phosphor Brass  
ELECTRICAL:  
Current rating: 15A  
Contact resistance: 20mΩ max  
Insulator resistance: 1000 MΩ min500 VDC  
Dielectric withstanding voltage: 1000V AC  
Operating temperature: -55° C to +125° C

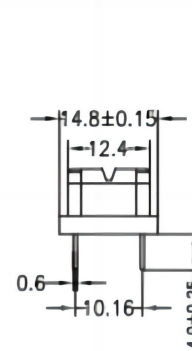

HLAL- 52 15 3 \* \* D  
52: Female  
Position: 15  
Dip Length: (mm) 3:4.0  
D: (Blank) DIP  
00: G/F 02: 2u" 03: 3u"  
05: 5u" 10: 10u" 15: 15u" 30: 30u"  
0: N/O  
C: Dip Tin Contact Gold  
G: Gold  
T: Tin

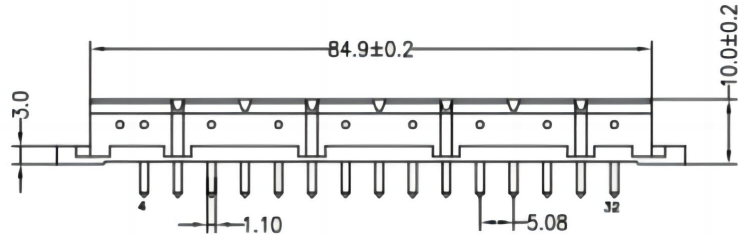
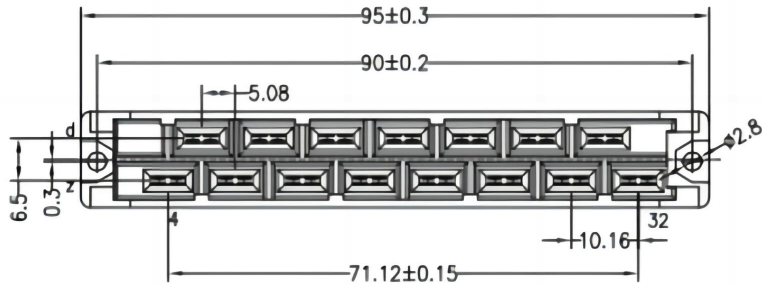
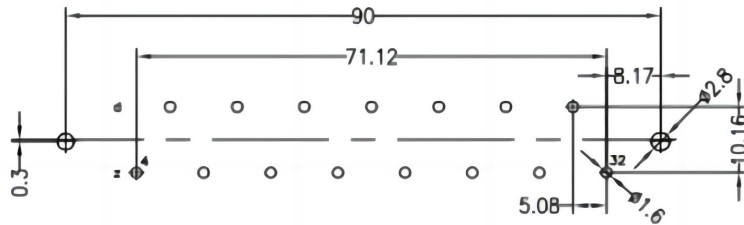

PCB LAYOUT(RECOMMENDED)  
(TOP VIEW TOL. :±0.05)

UNIT : mm

Beijing Hongli Kunpeng  
International Trade Co., LTD

MODEL NAME:  
DIN41612 large current 215  
straight H15

SELECT	1	2	3	EXTRA
DIM TOL	0.000	0.05	0.05	0.10
	0.00	0.10	0.15	0.20
	0.0	0.15	0.25	0.30
	0.	0.25	0.30	0.40
ANGLE	1.0°	3.0°	5.0°	

PART NO. HLAL-52153\*\*D  
APPROVED BY: FILE NO. DIN308-46  
CHECKED BY: SCALE:  
DRAW BY: jenny DATE : 2021.8.7